



Orange

Public Schools

Where We Do Great Things!

**ORANGE BOARD OF EDUCATION
SUPERINTENDENT'S FORUM**

SEPTEMBER 4, 2018



ORANGE BOARD OF EDUCATION VISION AND MISSION STATEMENTS

VISION STATEMENT

"The Orange Public School District commits to provide a **safe** and **caring environment** where each student is expected to **grow and succeed**.

We pledge to prepare all students with equitable opportunities for college and career readiness, leading to lifelong learning and responsible citizenship in a competitive global community."

MISSION STATEMENT

- The Orange Public School District in collaboration with all stakeholders is responsible for **promoting the academic, social, emotional and personal success of all students.**
- **With a commitment to academic excellence, the district provides teachers, families, and administrators the tools needed for all students to reach their full potential.**
- The district serves **all students** in our schools, **acknowledging their unique backgrounds, cultural perspectives and learning styles.**
- The district recognizes that curiosity, discipline, integrity, responsibility and respect are necessary for success.
- The Orange Public School District cultivates **a community of 21st century learners where students take ownership of the learning process, achieve high standards of excellence, and focus on academics.**
- **No Alibis, No Exceptions, No Excuses!**

DISTRICT OVERVIEW SUMMARY

In District Enrollment (Including Pre-K)

Enrollment

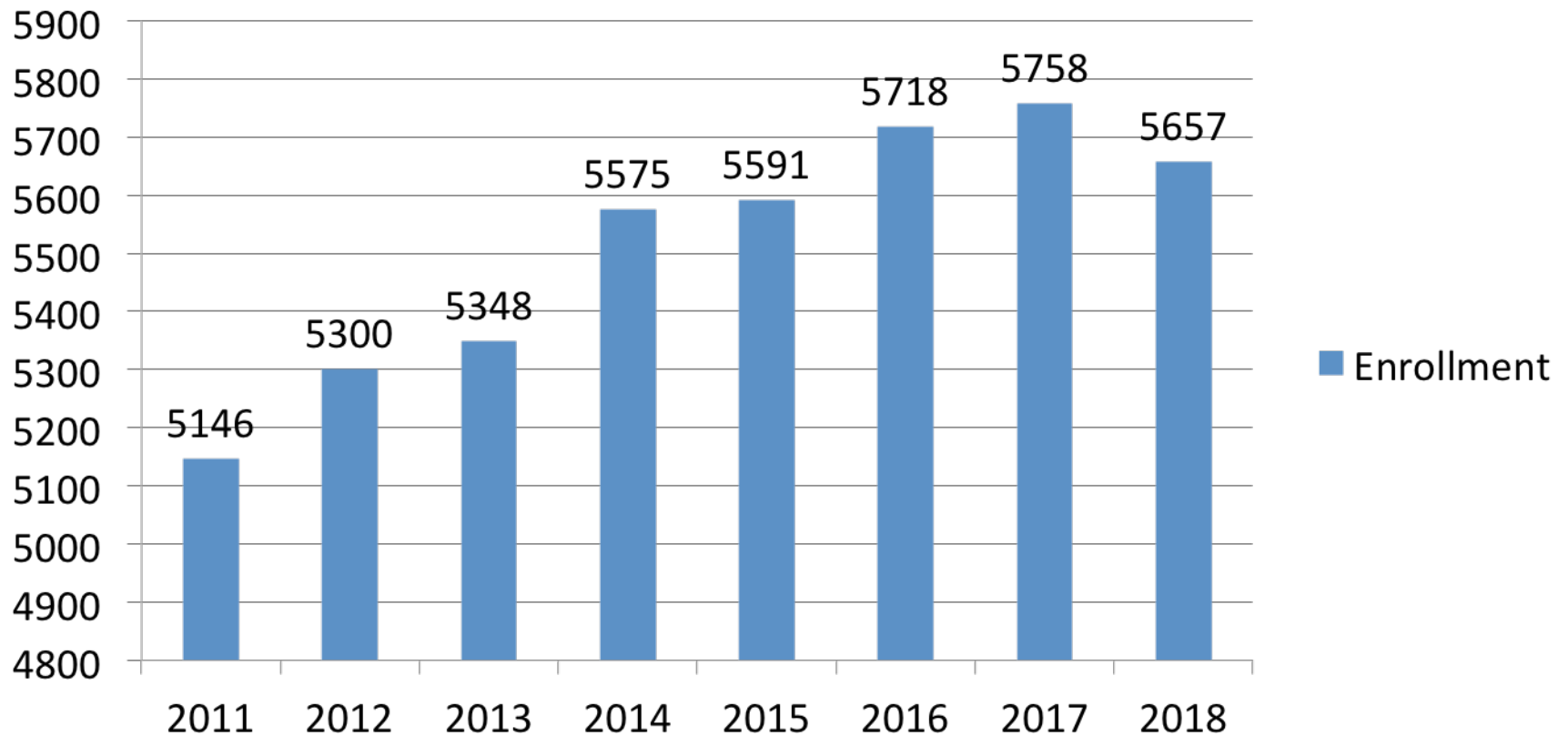

Orange High School 4 Year Graduation Rates

(*2018 Data Preliminary per NJSMART)

Graduation Rate

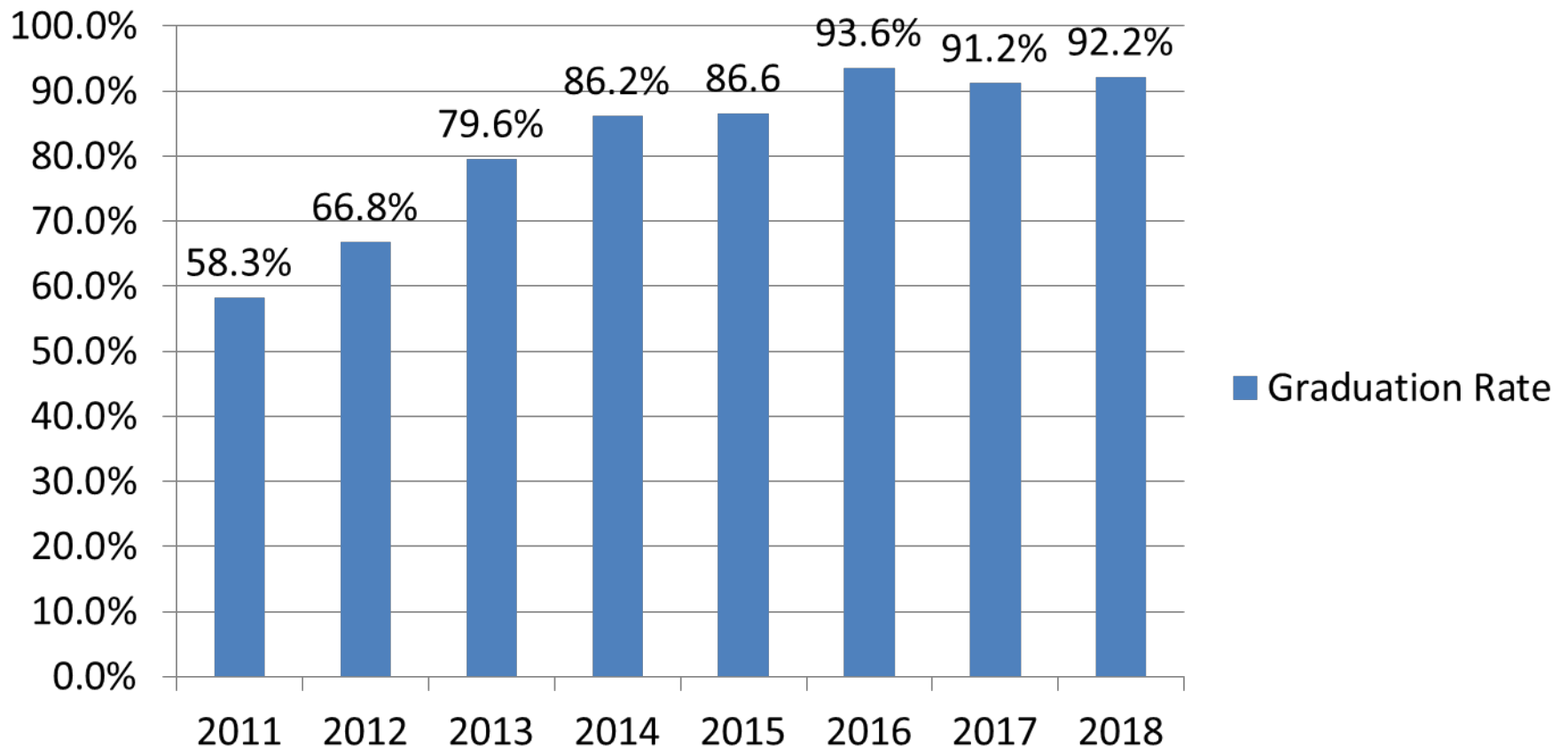

Table of Contents

FINANCIALS:

- ❖ 3 Year Revenue Comparison

FACILITIES UPDATE:

- ❖ District's Funded Projects
- ❖ Bond Information

3 Years Revenue Comparison

REVENUE SOURCE	2016-17	2017-18	2018-19	\$ CHANGE 17-18 Vs 18-19
Local Tax Levy	\$ 11,926,141	\$ 12,164,664	\$ 12,164,664	\$ -
Tuition	194,524	140,000	200,000	60,000
Miscellaneous	170,000	170,000	261,000	91,000
State Aid	74,020,695	75,202,477	78,604,954	3,402,477
Extra-ordinary Aid	604,749	432,340	600,000	167,660
Semi Medicaid	229,503	145,436	143,663	(1,773)
Interest on Investments	45,000	35,000	45,000	10,000
Budgeted Fund Balance	2,550,000	2,000,000	2,600,000	600,000
TOTAL BUDGET	\$ 89,740,612	\$ 90,289,917	\$ 94,619,281	\$ 4,329,364

FACILITIES UPDATE / SDA PROJECT

OHS Addition - Target Space Program

	Qty.	Occ.	Total Occ.	SF	Total SF
General Classrooms	15	24	360	750	11,250
Art Classrooms	3	24	72	1,250	3,750
Drama Classroom	1	24	24	1,200	1,200
Technology Lab	2	24	48	1,600	3,200
Robotics Lab	1	24	24	1,600	1,600
Auxiliary Gym	1	48	48	5,200	5,200
Media Center	1	0	0	5,000	5,000
Remote Admin. Office	2	0	0	150	300
Total Net SF					31,500
Circulation					
Support Spaces					
Grossing Factor					1.55
Total Grossing Factor SF					17,325
Total Gross SF					48,825

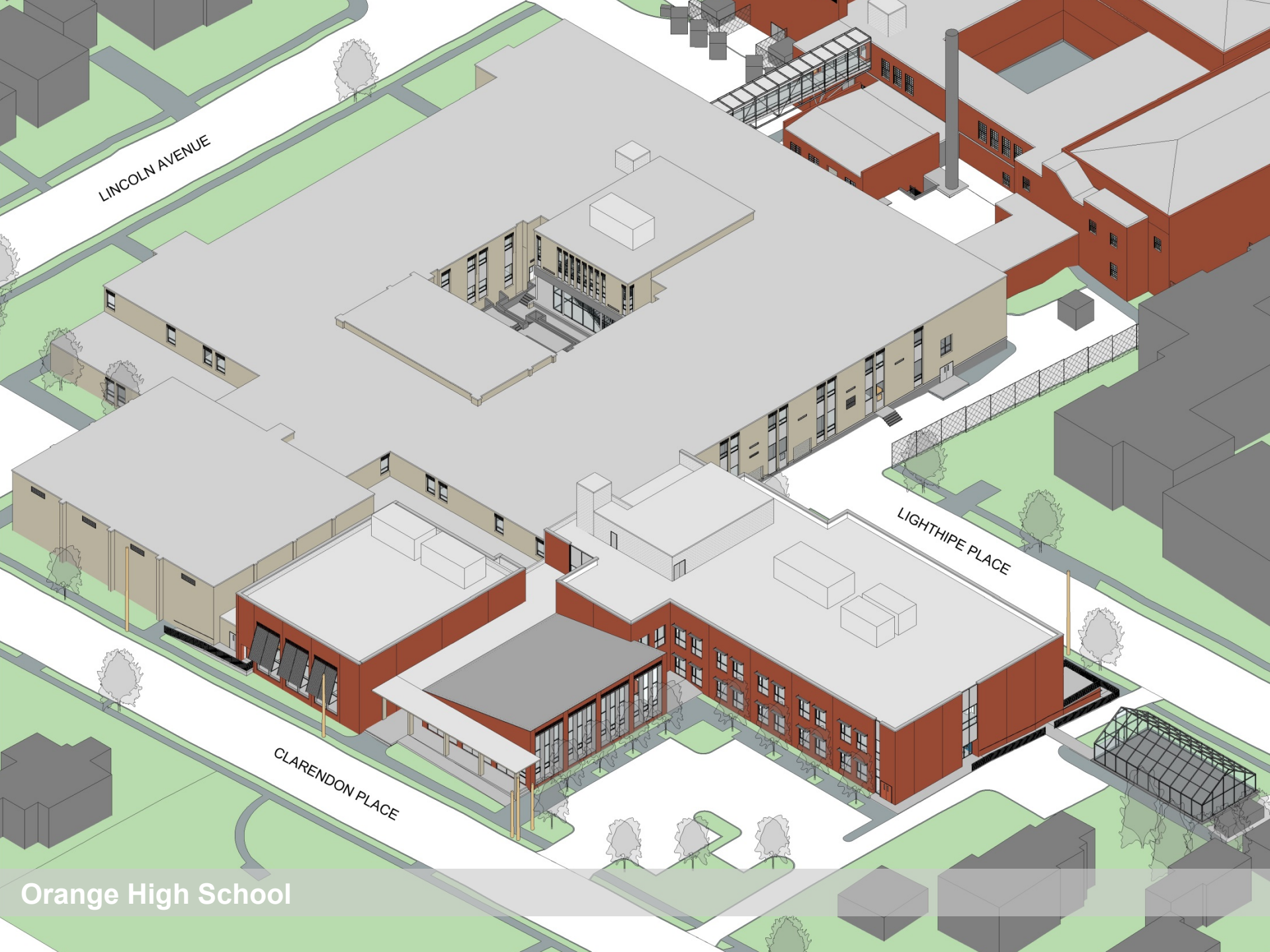

LINCOLN AVENUE

LIGHTHIPE PLACE

CLARENDON PLACE

Orange High School



YEZZI
 ASSOCIATE
 ARCHITECTURE
 PLANNING
 ENGINEERING
 INTERIORS
 MANAGEMENT

18 Washington Street
 P.O. Box 1838
 Torrington, CT 06774
 Tel: 732-240-3433
 Fax: 732-240-3463
 E-mail: info@yezziassociates.com
 Website: www.yezziassociates.com

Masimo Tomoa Yezzi, Jr.
 Architect No. C-1415 -LL
 Planner No. 2568 -LL
 Architect No. 019392 -W
 Architect No. 0173999 -W
 Architect No. 7460 -CT
 Architect No. 8473 -W
 Architect No. 5875 -SO
 Architect No. 22384 -CT
 Architect No. 5733 -W
 Architect No. 9787-003 -NCARB
 Architect No. 39914 -NCARB
 Architect No. 3358177 -LL

Gregory J. Perugini
 Architect No. 4743 -AZ
 Architect No. 407345 -CO
 Architect No. 485241 -MS
 Architect No. 18348 -MS
 Architect No. 032031-1 -W
 Architect No. 003-000308-11
 Architect No. 21314 -TX
 Architect No. 1068-003 -MS
 Architect No. 92506 -NCARB
 LEED Accredited Professional

Daniel M. Sernotti
 21401307600-NA Architect
 No. 73872 -NCARB

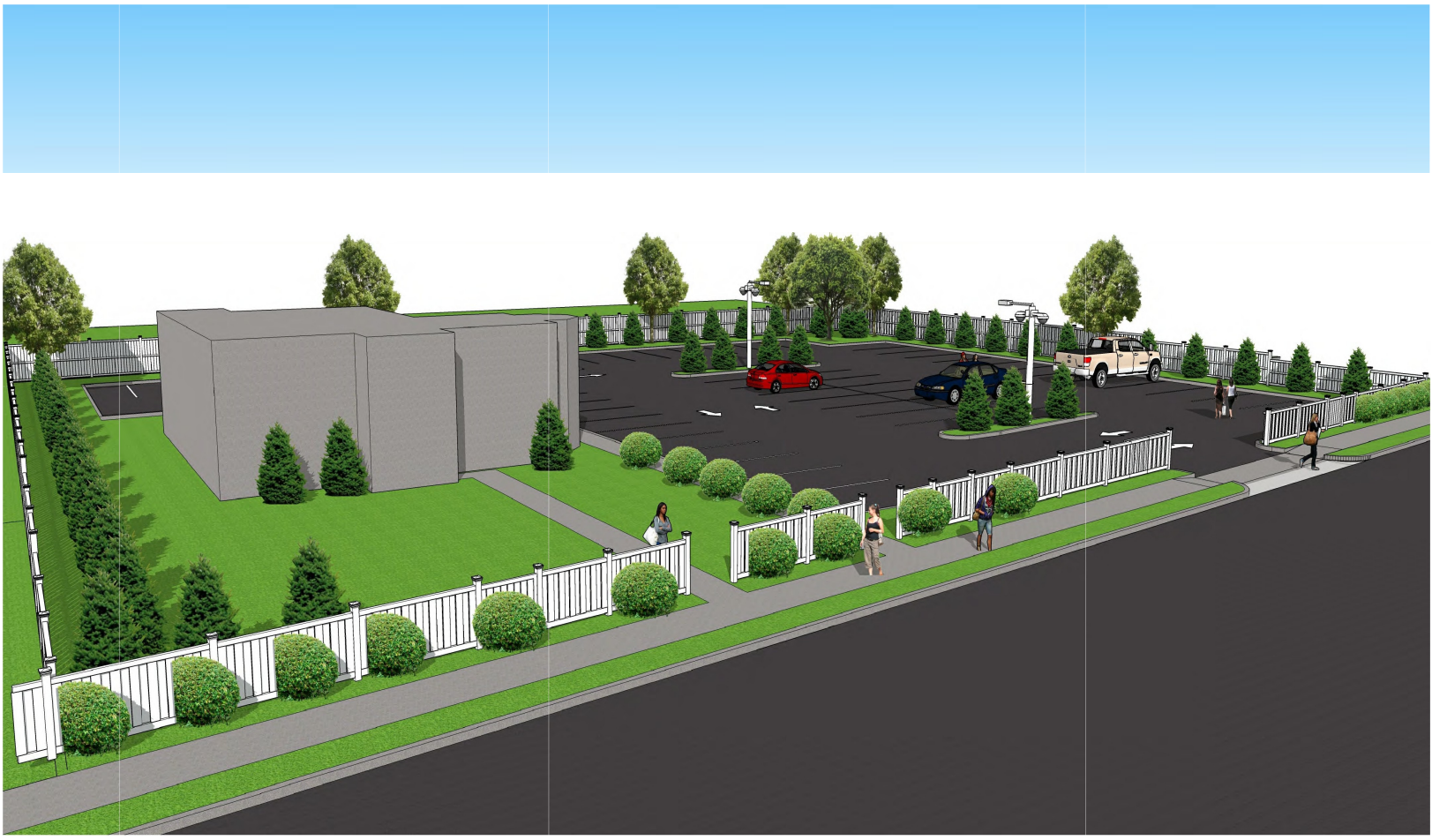

Figure

1- III
 2- II
 3- I
 4- I
 5- I
 6- I
 7- I
 8- I
 9- I
 10- I
 11- I
 12- I
 13- I
 14- I
 15- I
 16- I
 17- I
 18- I
 19- I
 20- I
 21- I
 22- I
 23- I
 24- I
 25- I
 26- I
 27- I
 28- I
 29- I
 30- I
 31- I
 32- I
 33- I
 34- I
 35- I
 36- I
 37- I
 38- I
 39- I
 40- I
 41- I
 42- I
 43- I
 44- I
 45- I
 46- I
 47- I
 48- I
 49- I
 50- I
 51- I
 52- I
 53- I
 54- I
 55- I
 56- I
 57- I
 58- I
 59- I
 60- I
 61- I
 62- I
 63- I
 64- I
 65- I
 66- I
 67- I
 68- I
 69- I
 70- I
 71- I
 72- I
 73- I
 74- I
 75- I
 76- I
 77- I
 78- I
 79- I
 80- I
 81- I
 82- I
 83- I
 84- I
 85- I
 86- I
 87- I
 88- I
 89- I
 90- I
 91- I
 92- I
 93- I
 94- I
 95- I
 96- I
 97- I
 98- I
 99- I
 100- I

Project File

Date

Revision

1

3D VIEW 2

GP	
1/4"	
1/8"	
1/2"	4

3D VIEW 1
 P.3 SCALE: N.T.S.

SDA PROJECT- Cleveland Elem. School Addition/Renovation

Additions:

- ✓ Multipurpose room (4,800 SF) with Stage (1,200 SF)
- ✓ Prep. Kitchen with server (1,200 SF)
- ✓ Main Lobby & Security Post
- ✓ Boys & Girls rest rooms (on 3rd Floor)

Program-driven Renovations:

- ✓ Child study team space
- ✓ Small group instruction space
- ✓ Toilets for Nurse's office & Staff (on each floor)
- ✓ Art & Science Project labs
- ✓ Self-contained Special Education classroom
- ✓ Custodial & Building support space

Cleveland School will be relocated to Our Lady of the Valley School while construction is going on (for approx. two & half School years)



CLEVELAND STREET ELEMENTARY SCHOOL

CLEVELAND STREET
ELEMENTARY SCHOOL

BOND INFORMATION

Bond for the sum of \$3.7 million was approved on January 12, 2016 to fund the following Capital Projects:

✓ New Playground & Play Equipment (Forest, Heywood, Oakwood, Central & Scholars) -	\$ 475,000
✓ Window Repair & Replacement (Oakwood)	\$ 75,000
✓ Parking lots Repaving	\$ 662,306
✓ Renovations & Fit out	\$ 96,750
✓ Trailer Doors replacement/Brick repointing	\$ 15,000
✓ Concrete Pave way & Drainage Repairs	\$ 110,000
✓ Boilers/HVAC Repair-Replacement	\$ 488,742
✓ Install/Renovate Building Security	\$ 221,500
✓ Greenhouse	\$ 110,000
✓ Auditorium Lights & Sound System	\$ 204,375
✓ Intercom Systems	\$ 175,500
✓ Property Acquisition	\$ 777,000
✓ Demolition	\$ 188,827
✓ Other Projects	<u>\$ 100,000</u>

TOTAL \$ 3,700,000



PARCC RESULTS:

**ORANGE BOARD OF EDUCATION
2018**

DISTRICT GOALS

2017-18

- 1. By June 2019, the Orange Board of Education will enhance and improve student achievement for all students, as measured by a minimum 20 percentage point increase on the PARCC assessments in Mathematics and English Language Arts per grade over the 2017 baseline. (10 percentage points in 2018 and 10 percentage points in 2019)

ELA

Grade/ Subject	2015 % Met Expectations/ Exceeded Expectations	2016 % Met Expectations/ Exceeded Expectations	2017 % Met Expectations/ Exceeded Expectations	2018 Orange % Met Expectations/ Exceeded Expectations	2018 New Jersey % Met Expectations/ Exceeded Expectations	Orange Difference	NJ Difference
3	14%	23%	28%	30.0%	51.7%	+2	+1.7
4	24%	24%	30%	34.5%	58.0%	+4.5	+2
5	24%	30%	31%	31.8%	58.0%	+0.8	-1
6	25%	30%	37%	38.4%	56.2%	+1.4	+3.2
7	30%	34%	37%	55.8%	62.7%	+18.8	+3.7
8	31%	34%	36%	34.6%	60.4%	-1.4	+1.4
9	24%	25%	24%	26.6%	54.1%	+2.6	+3.1
10	12%	26%	21%	24.6%	49.9%	+3.6	+5.9
11	21%	24%	29%	32.9%	38.1%	+3.9	+1.1

PARCC Performance levels

- Level 1: Not yet meeting grade-level expectations
- Level 2: Partially meeting grade-level expectations
- Level 3: Approaching grade-level expectations
- Level 4: Meeting grade-level expectations
- Level 5: Exceeding grade-level expectations

Orange Public Schools'

2018 PARCC GRADE-LEVEL Outcomes

English Language Arts/Literacy

	Count of Valid Test Scores	Not Yet Meeting (Level 1)	Partially Meeting (Level 2)	Approaching Expectations (Level 3)	Meeting Expectations (Level 4)	Exceeding Expectation (Level 5)	District % >= Level 4	NJ % >= Level 4
Grade 3	443	24.6%	19.4%	26.0%	28.0%	2.0%	30%	51.7
Grade 4	368	13.9%	24.7%	26.9%	31.8%	2.7%	34.5%	58.0%
Grade 5	384	14.8%	24.0%	29.4%	29.4%	2.3%	31.8%	58.0%
Grade 6	388	7.5%	22.2%	32.0%	33.5%	4.9%	38.4%	56.3%
Grade 7	326	12.0%	12.3%	19.9%	39.0%	16.9%	55.8%	62.7%
Grade 8	315	15.9%	18.7%	30.8%	28.3%	6.3%	34.6%	60.4%
Grade 9	271	28.8%	20.3%	24.4%	22.1%	4.4%	26.6%	54.1%
Grade 10	309	33.3%	20.4%	21.7%	20.4%	4.2%	24.6%	49.9%
Grade 11	286	22.4%	18.9%	25.9%	26.6%	6.3%	32.9%	38.1%

ELA Disaggregated Data

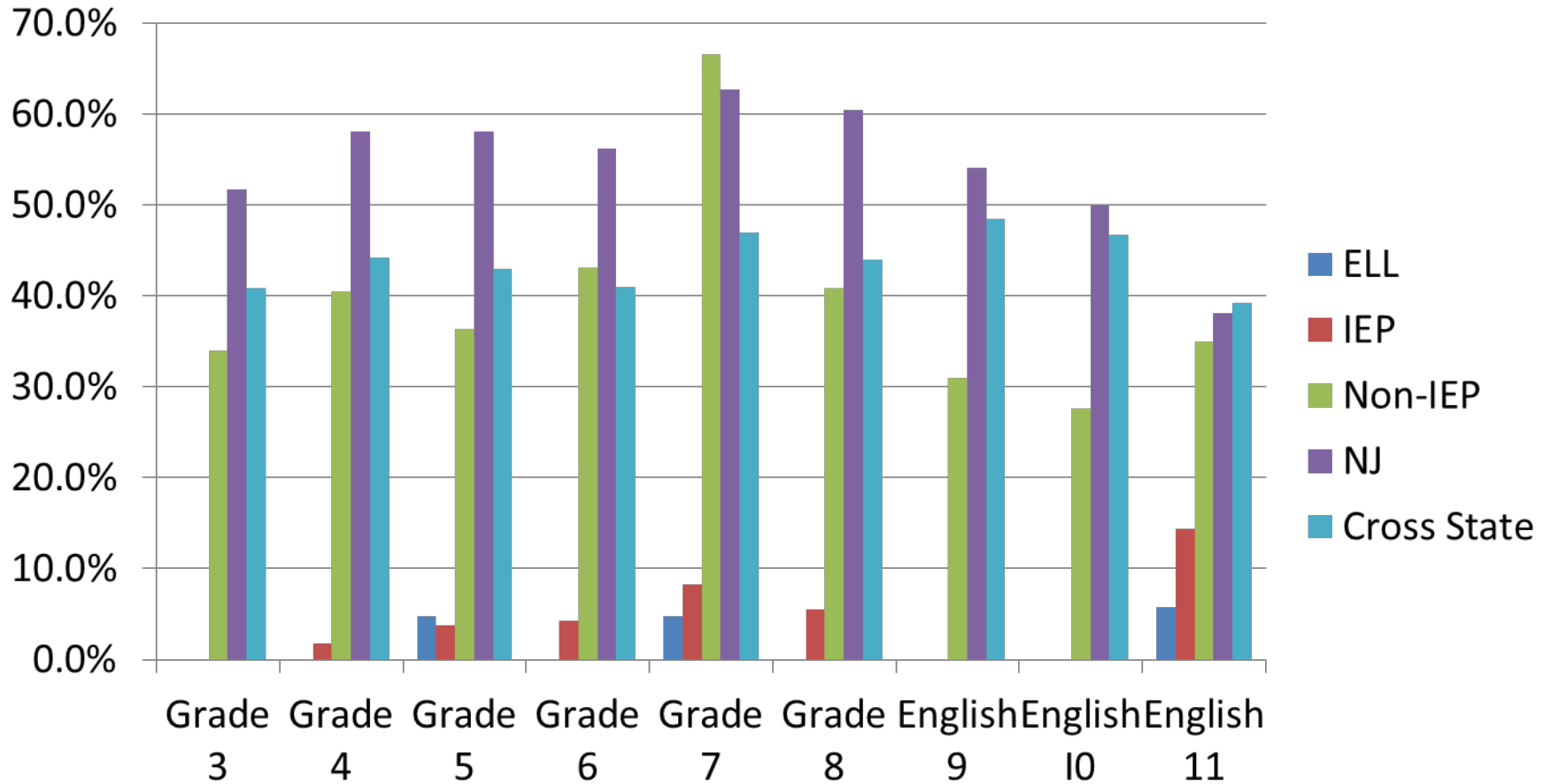

Mathematics

Grade/ Subject	2015 % Met Expectations/ Exceeded Expectations	2016 % Met Expectations/ Exceeded Expectations	2017 % Met Expectations/ Exceeded Expectations	2018 % Met Expectations/ Exceeded Expectations	2018 New Jersey % Met Expectations/ Exceeded Expectations	Orange Difference	NJ Difference
3	15%	28%	26%	29.5%	53.0%	+3.5	0.0
4	19%	20%	24%	27.2%	49.4%	+3.2	+1.4
5	18%	21%	17%	21.4%	48.8%	+4.4	+2.8
6	15%	15%	18%	22.1%	43.5%	+4.1	-0.5
7	18%	16%	17%	26.7%	43.4%	+9.7	-3.4
8	13%	17%	9%	11.0%	28.2%	+2	-9.8
Algebra I	23%	25%	16%	25.3%	45.8%	+9.3	+3.8
Algebra II	9%	14%	12%	4.0%	28.6%	-8	+1.6
Geometry	Scores suppressed	11%	10%	20.5%	29.5%	+10.5	-0.5

ORANGE PUBLIC SCHOOLS

2018 PARCC GRADE-LEVEL Outcomes

Mathematics

	Count of Valid Test Scores	Not Yet Meeting (Level 1)	Partially Meeting (Level 2)	Approaching Expectations (Level 3)	Meeting Expectations (Level 4)	Exceeding Expectation (Level 5)	District % >= Level 4	NJ % >= Level 4
Grade 3	455	16.5%	23.7%	30.3%	25.3%	4.2%	29.5%	53.0%
Grade 4	375	18.9%	24.8%	29.1%	26.9%	0.3%	27.2%	49.4%
Grade 5	392	22.2%	29.6%	26.8%	20.7%	0.8%	21.4%	48.8%
Grade 6	398	19.1%	31.2%	27.6%	20.9%	1.3%	22.1%	43.5%
Grade 7	330	12.1%	31.5%	29.7%	23.3%	3.3%	26.7%	43.4%
Grade 8	283	36.7%	26.5%	25.8%	11.0%	0.0%	11.0%	28.2%
Algebra I	292	25.3%	29.1%	20.2%	22.6%	2.7%	25.3%	45.8%
Algebra II	302	52.6%	29.1%	14.2%	4.0%	0.0%	4.0%	28.6%
Geometry	307	14.7%	43.3%	21.5%	19.9%	0.7%	20.5%	29.5%

Mathematics by School

	3	4	5	6	7	8	Algebra I	Algebra II	Geometry
CIAO							Suppressed	Suppressed	Suppressed
Cleveland	35.9%	20.8%	20.0%	37.9	25.6%				
Forest	27.1%	28.2%	31.6%	20.0%	17.9%				
Heywood	35.3%	40.0%	22.0%	21.7%	16.7%				
Lincoln	25.5%	14.7%	15.2%	17.4%	27.0%				
Oakwood	34.6%	21.1%	12.0%	15.8%	5.3%				
OHS							0.0%	3.7%	15.3
OPA						11.0%	29.1%	50.0%	90.9%
Park	34.5%	28.6%	22.4%	17.9%	29.7%				
RPCS	27.1%	34.4%	24.3%	25.9%	38.4%				
State Avg.	53.0%	49.4%	48.8%	43.5%	43.4%	28.2%	45.8%	28.6%	29.5%

Mathematics Disaggregated Data

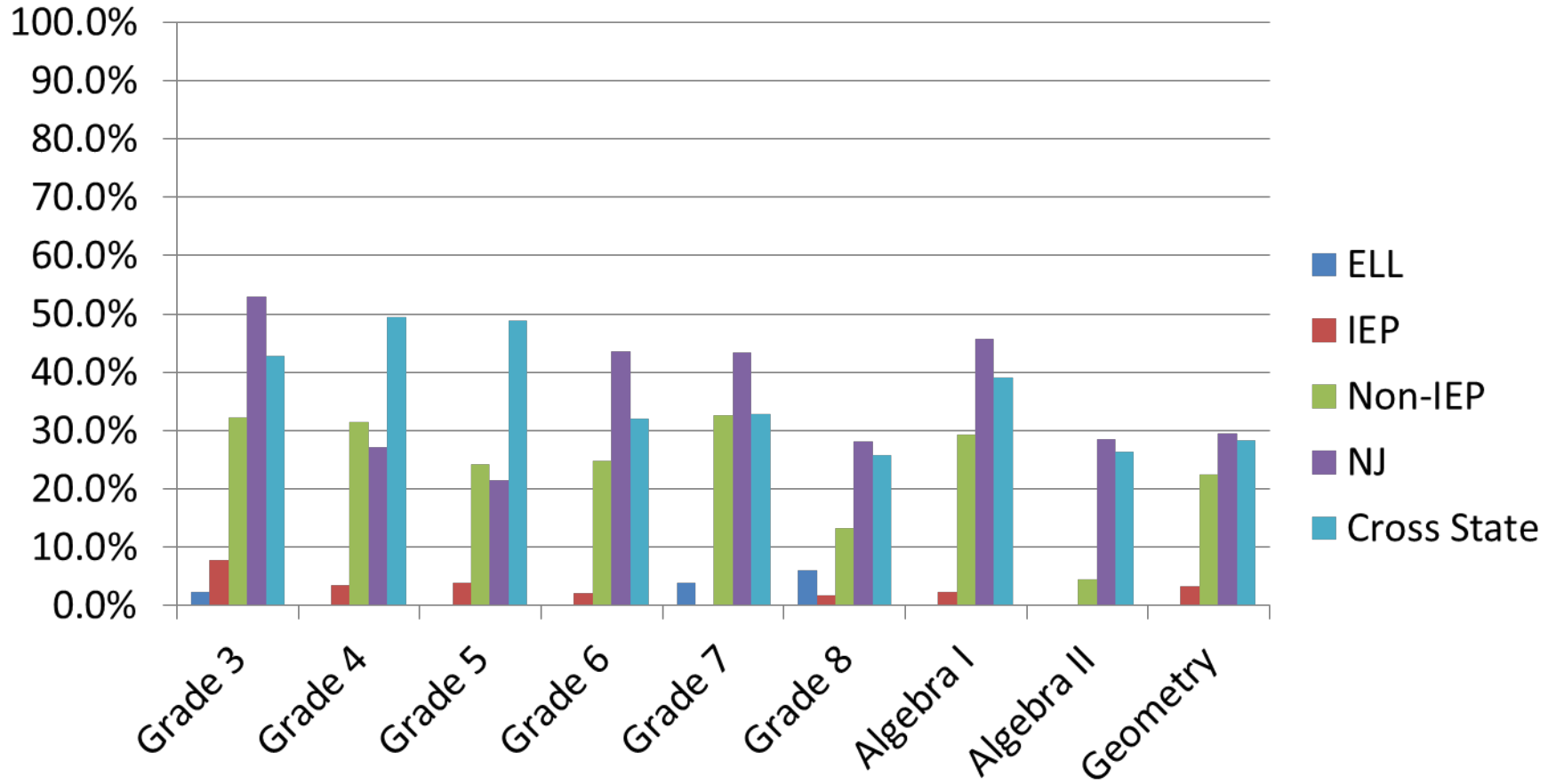

DISTRICT GOALS

2017-18

- 1. By June 2019, the Orange Board of Education will enhance and improve student achievement for all students, as measured by a minimum 20 percentage point increase on the PARCC assessments in Mathematics and English Language Arts per grade over the 2017 baseline. (10 percentage points in 2018 and 10 percentage points in 2019)

ELA **10 Point** Improvement in Same Grade Level 2017 compared with 2018

Forest	Grade 4	11.2 pts.
Forest	Grade 5	20.5 pts.
Heywood	Grade 7	15.6 pts.
Lincoln	Grade 7	26.3 pts.
Oakwood	Grade 4	15.1 pts.
Oakwood	Grade 6	11.3 pts.
Park	Grade 3	22.9 pts.
Park	Grade 7	30.5 pts.
RPCS	Grade 7	20 pts.

ELA 5 to 9.9 Point Improvement in Same Grade Level 2017 compared with 2018

Cleveland	Grade 7	6.5 pts.
Forest	Grade 6	7.3 pts.
Heywood	Grade 3	5.4 pts.
Heywood	Grade 4	7.3 pts.
Heywood	Grade 5	8.9 pts.
Heywood	Grade 6	8.7 pts.
Lincoln	Grade 3	9.2 pts.
Oakwood	Grade 3	7.6 pts.
Oakwood	Grade 7	9.6 pts.
Park	Grade 5	5.8 pts.
RPCS	Grade 4	5.8 pts.
RPCS	Grade 5	6.1 pts.
RPCS	Grade 6	8.4 pts.

PARCC ELA **10 Point** Improvement by Cohort

2017 compared with 2018

Cleveland	Grade 6	15.4 pts.
Forest	Grade 5	25.5 pts.
Forest	Grade 6	13.2 pts.
Forest	Grade 7	21.7 pts.
Heywood	Grade 4	18.3 pts.
Heywood	Grade 6	11.7 pts.
Heywood	Grade 7	17.6 pts
Lincoln	Grade 7	16.3 pts.
Oakwood	Grade 4	15.1 pts.
Oakwood	Grade 7	16.6 pts.
OHS	Grade 11	12 pts.
Park	Grade 4	16.5 pts.
Park	Grade 7	26.5 pts.
RPCS	Grade 6	10.4 pts
RPCS	Grade 7	29 pts.

**PARCC ELA 5 to 9.9 Point Improvement
by Cohort
2017 compared with 2018**

Park	Grade6	9.9 pts.
RPCS	Grade 4	9.8 pts.

**Mathematics 10 Point Improvement
in Same Grade Level
2017 compared with 2018**

Cleveland	Grade 6	19.9 pts.
Forest	Grade 5	11.6 pts.
Heywood	Grade 4	14 pts.
Lincoln	Grade 3	14.5 pts.
Lincoln	Grade 7	13 pts.
Oakwood	Grade 6	15.8 pts.
RPCS	Grade 7	19.4 pts.

Mathematics **5 to 9.9** Point Improvement in Same Grade Level 2017 compared with 2018

Cleveland	Grade 3	8.9 pts.
Cleveland	Grade 7	8.6 pts.
Heywood	Grade 3	6.3 pts.
Oakwood	Grade 4	9.1 pts.
Park	Grade 3	7.5 pts.
Park	Grade 7	8.7 pts.
RPCS	Grade 4	6.4 pts.
RPCS	Grade 5	8.3 pts.

**PARCC MATHEMATICS 10 Point Improvement
by Cohort
2017 compared with 2018**

Cleveland	Grade 6	21.9 pts.
Heywood	Grade 4	31 pts.
Lincoln	Grade 7	12 pts.
RPCS	Grade 7	17.4 pts.

PARCC Mathematics **5 to 9.9** Point Improvement by Cohort

2017 compared with 2018

Forest	Grade 5	7.6 pts.
Lincoln	Grade 5	5.2 pts.
Oakwood	Grade 7	5.3 pts.
Park	Grade 7	9.7 pts.
RPCS	Grade 6	9.9 pts.

Growth Analysis

of Tested Grades for ELA and Math Combined

		Grade	Analysis			Cohort	Analysis		
	<u>>10%</u>	<u>>5%</u>	<u>Loss</u>			<u>>10%</u>	<u>>5%</u>	<u>Loss</u>	
CIAO		Suppressed					Suppressed		
Cleveland	2	4	2			2	1	1	
Forest	2	3	2			3	1	1	
Heywood	3	1	1			4	0	4	
Lincoln	3	1	4			2	1	3	
Oakwood	5	1	3			2	2	3	
OHS	0	1	1			2	0	0	
OPA	0	1	2			2	0	0	
Park	3	1	2			2	1	3	
RPCS	2	3	2			3	2	1	

School Growth Points

- **5 Points** was awarded for each grade band and/or cohort that met the 10 point district growth goal on PARCC
- **3 Points** was awarded for each grade band and/or cohort that increased between 5 Points and 10 points on PARCC
- **5 Points** was deducted for each grade band and/or cohort that decreased on PARCC

TOP 2 SCHOOLS AWARDED GROWTH POINTS

1ST PLACE - ROSA PARKS COMMUNITY SCHOOL

2ND PLACE - FOREST STREET COMMUNITY SCHOOL

High School AP Results

School Year	# of Exams Taken	# Passing (score of 3-5)	% Passing
2015	156	25	16.0%
2016	154	36	23.4%
2017	155	45	29.0%
2018	181	88	48.6%

Orange Public Schools

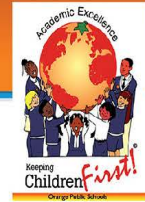

WHERE WE DO GREAT THINGS!

**ORANGE HIGH SCHOOL
2018 AP CALCULUS EXAM**

**95% PASS
RATE**

OUTFRONT



Child Development

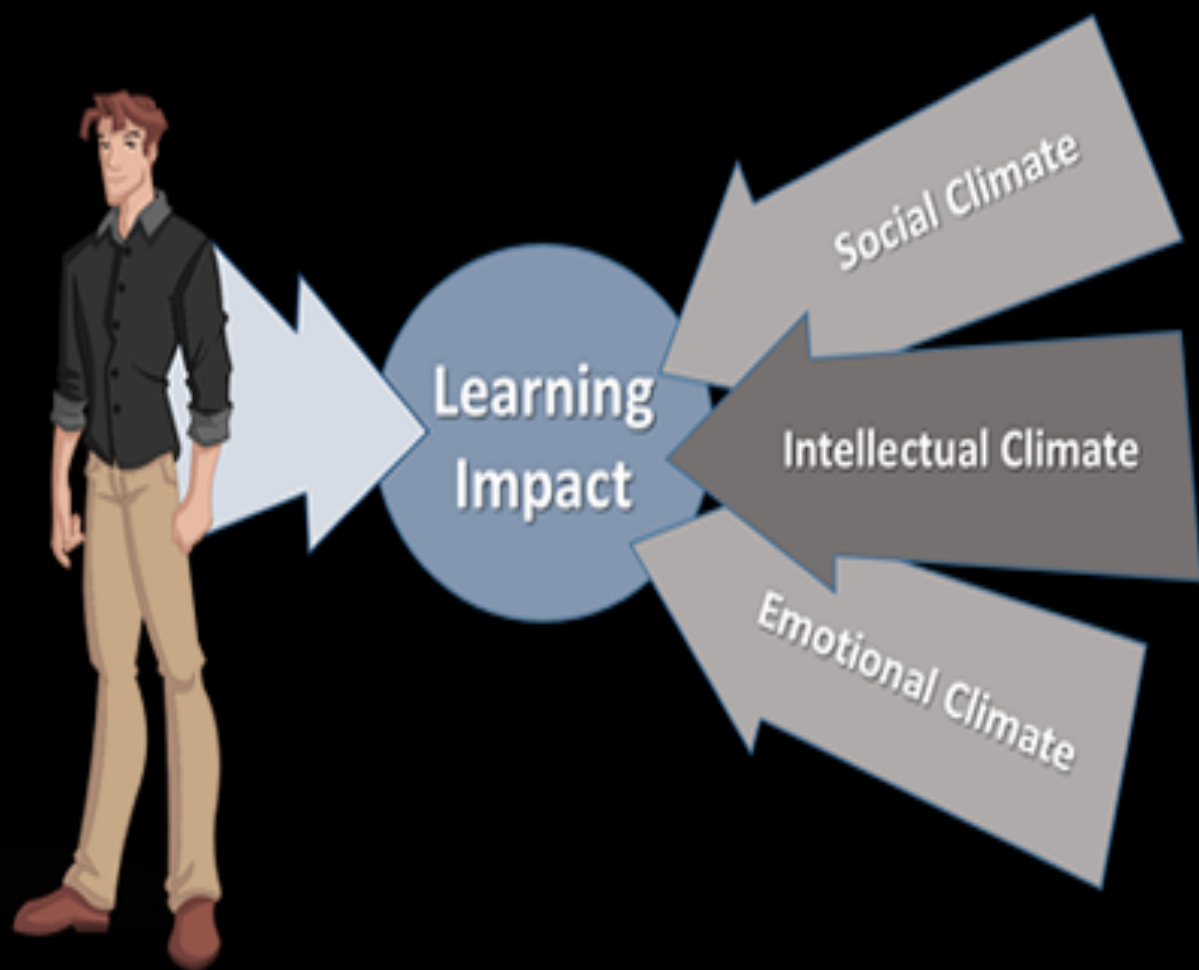





The principle goal of education in the schools should be creating men and women who are capable of doing new things, not simply repeating what other generations have done.

— *Jean Piaget* —

AZ QUOTES

Changes and Focus for 2018-19

- New Alternative Program for Students in Grades 6-8
- Reducing the Number of Assessments given to Students
- Start the Implementation of Social Emotional Learning (SEL) Practices
- Implementing and/or Expanding Restorative Justice Practices
- Student Developed Individualized Personal Growth Plans
- Creating New CTE Pathways

ELA Next Steps

- Focus on engagement with complex texts and language standards to improve writing
- Ensure adherence to the literacy block (intentional whole group, small group, independent work, and targeted instruction)
- Increase digital silent reading support and practice
- Build knowledge, strengthen comprehension, and increase fluency

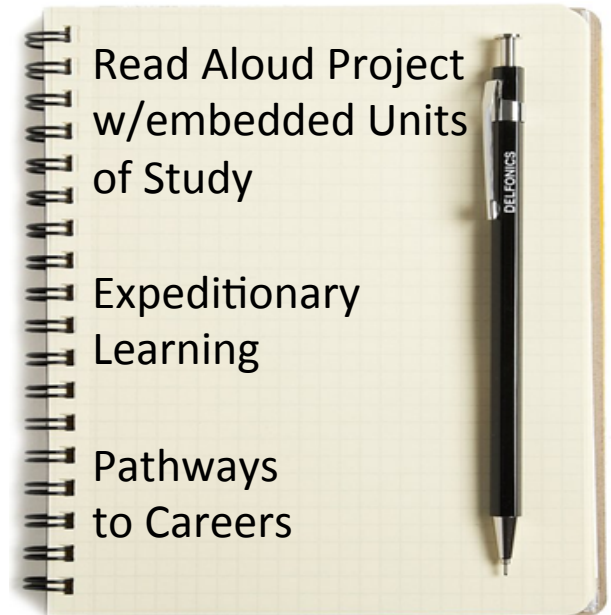
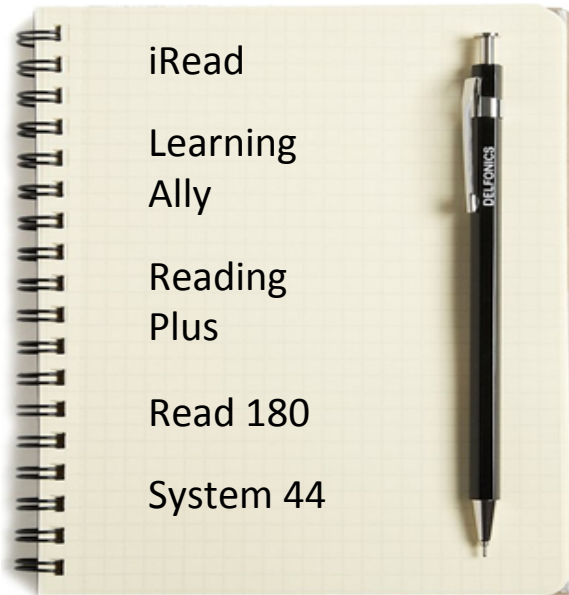
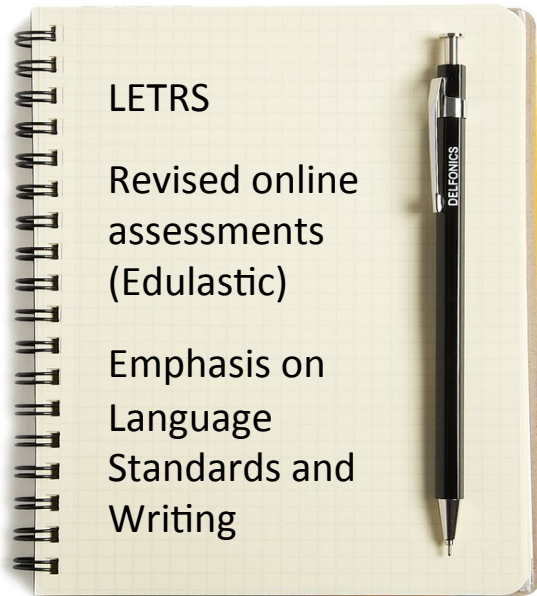

Mathematics Next Steps

- Continued focus on the Big Rocks
- Emphasis on focus, coherence, and rigor in the classroom
 - Tasks that promote reasoning and problem solving
 - Emphasis on visual representation
 - Promoting student thinking
 - Promoting Mathematical Discourse

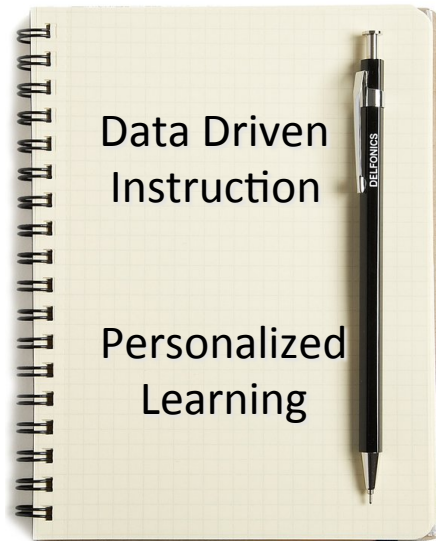

Science Next Steps

- Continued focus on Phenomena
- Emphasis on the 5E's of instruction
- Introducing Common Authentic Assessments
 - Building Community
- Promoting Reading Comprehension via Scientific Texts

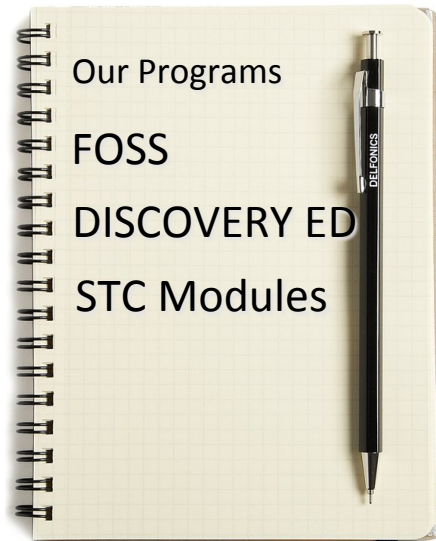

ORANGE BOARD OF EDUCATION

2018-19
GOALS

District Goals

2018-2019

1. Student Achievement and Growth

- a. By June 2019, for all **3-11 grades**, the Orange Board of Education will enhance and improve student achievement for all students, as measured by a minimum increase of **10 percentage points**, either by grade band or cohort, on the PARCC assessments in mathematics and English Language Arts over the 2018 baseline scores.
- b. By June 2019, **80%** of all **K-2** students will demonstrate improved academic achievement as measured by scoring at or above end of year growth norms/expectations as measured by performance on content-related assessments in ELA and Mathematics (e.g. iRead, Reading Inventory, iReady).

District Goals

2018-2019

2. Development of Individualized Student Academic and Growth Plans

a. **Every Teacher** will meet with **all their students** to collaboratively assist them in **developing their academic and growth goals**. Teachers will meet at least **twice per semester** with their students to review their status toward the attainment of their goals.

- Framework

- Review History/Talk/Consult
- Test/Assessment
- Analyze Data
- Consult/Collaborate – Set Goal/Develop Plan
- Assessment
- Analyze Data
- Consult/Measure/Adjust, if necessary
- Praise Successes

District Goals

2018-2019

3. IMPROVING SCHOOL CLIMATE

- a. Implement **Social Emotional Learning Practices** for all students, as measured by the reduction of chronic absenteeism, in/out of school suspensions and HIB incidents through components listed below:
 - i. Top 20 Attributes
 - ii. HIB
 - iii. Unconscious Bias
 - iv. Chronic Absenteeism
 - v. Alternative Programs
 - vi. Restorative Justice

District Goals

2018-2019

4. SAFETY

- a. HIRING SCHOOL RESOURCE /LEVEL 3 OFFICERS

Aligning goals

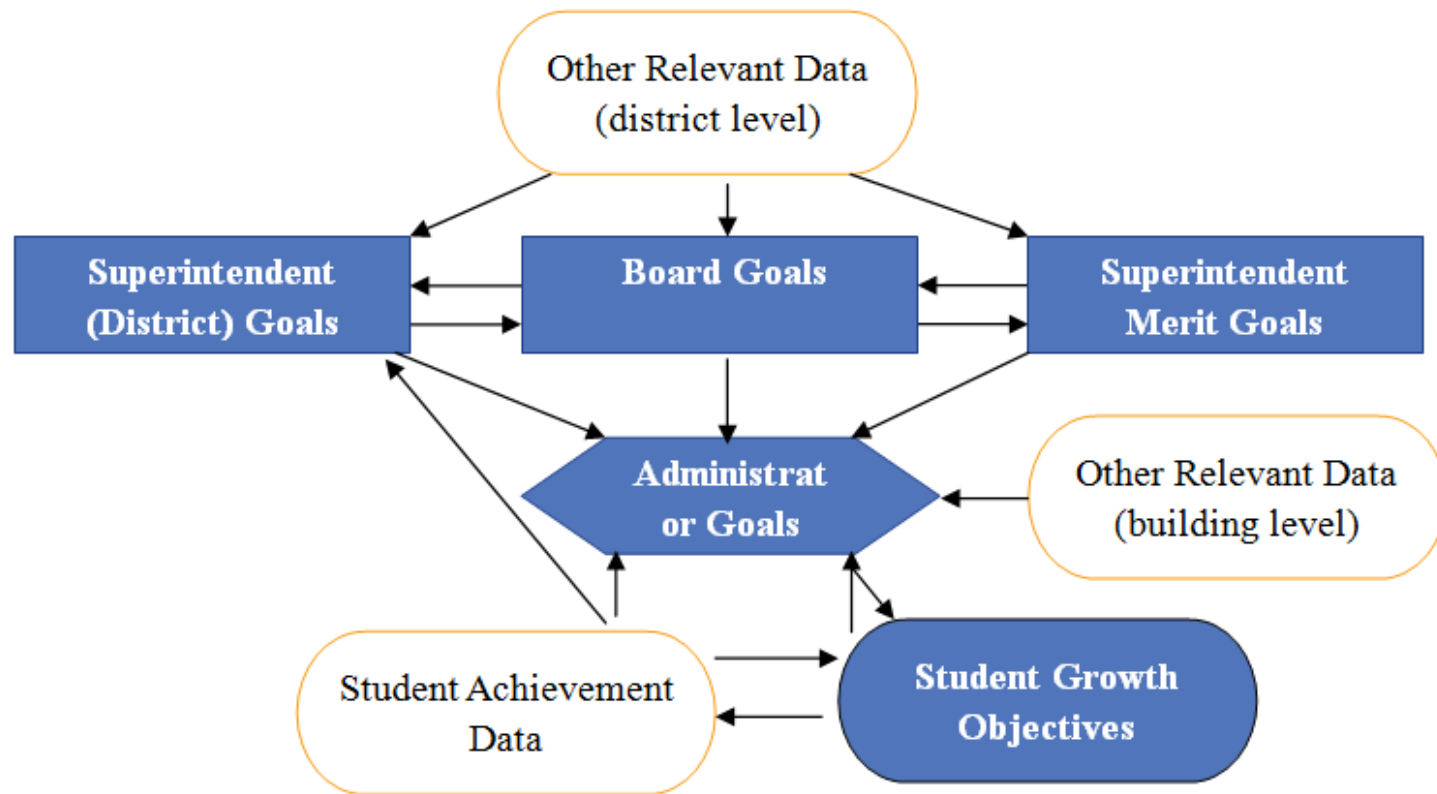



Orange

Public Schools

Where We Do Great Things!

Orange Public Schools

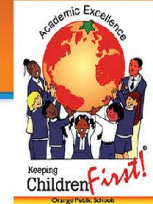

WHERE WE DO GREAT THINGS!

2018 COLLEGE ACCEPTANCES

STANFORD UNIVERSITY	PENN STATE UNIVERSITY	TUSKEGEE UNIVERSITY
DUKE UNIVERSITY	SYRACUSE UNIVERSITY	RUTGERS UNIVERSITY
NEW YORK UNIVERSITY	AMERICAN UNIVERSITY	SETON HALL UNIVERSITY
GEORGIA TECH	TEMPLE UNIVERSITY	NJIT
LEHIGH UNIVERSITY	HOWARD UNIVERSITY	KEAN UNIVERSITY
VILLANOVA UNIVERSITY	HAMPTON UNIVERSITY	MONTCLAIR STATE UNIVERSITY

OUTFRONT

Orange Public Schools

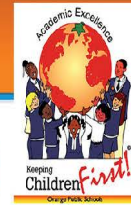

WHERE WE DO GREAT THINGS!

\$11.4 MILLION

IN SCHOLARSHIPS AND GRANTS

AWARDED TO THE 2018 GRADUATES

OUTFRONT



Want to be
**COLLEGE AND
CAREER READY?**
Start here.



Career & Technical Education Pathways

Digital Media: Collaboration with Drew University and Montclair State University. Learn to create your own films, write your own scripts, produce news shows, and learn technical editing skills. **OHS has its own studio!** Spend time on MSU's campus and compete for a **full college scholarship!** (MOU with Fairleigh Dickinson for dual enrollment credits is with FDU's lawyers for approval.)

Health Sciences: Collaboration with Rutgers University. **Earn 17 college credits while still in high school.** Prepare for a career in medicine, health, or biological sciences. Compete with other schools from around the United States through HOSA projects.

Graphic Design: Design and produce posters, public service announcements, flyers, tee shirts, and 3D designs utilizing **the latest technology.** Create your own webpages and learn gaming. **Earn Xerox certification** through editing and printing in Orange High School's own print shop! (MOU with Bloomfield College for dual enrollment is in process.)

Cisco: **Earn Cisco certification** and have a jump start on a career in computer technology and increase your chances at being accepted into highly competitive universities.

Culinary: **Earn ServSafe certification** while still in high school. Work in a state-of-the-art industrial kitchen. Have the potential to earn money preparing and serving meals as part of the Culinary Arts Club.

SMART Lab and Computer Applications: Explore STEM and media arts through applied technology and project-based learning. OHS and OPA have complete **STEM labs.** **Earn Microsoft Certification.**

Business Management and Accounting: Collaboration with Seton Hall University through the Junior MBA Program, **earning college credits** while still in high school. Participate in competitions with other schools in New Jersey, creating your own company! **Earn Accounting credits from Syracuse University** through dual enrollment.

All pathways have structured learning experiences during senior year—job shadowing, internships,



Orange

Public Schools

Where We Do Great Things!

**Orange
Academy Awards
7th Annual**

September 4, 2018





Highest 2016-17 SGP

This award recognizes teaching staff members with the highest Student Growth Percentile (SGP) in the district for 2016-17 school year as determined by data received through the New Jersey Department of Education's NJSMART system.

Highest SGPs

- Maisha Jones Lincoln - ELA
- Monique Walker Forest – ELA
- William Donnelly Forest – ESL/ELA
- Maria Beaghen Park - Math
- Jennifer Spatz Grant Lincoln - Math
- Jenelle Stokes Forest – ELA

School With The Highest Average SGP for 2016-17

**FOREST STREET
COMMUNITY SCHOOL**

Employee of the Year Awards

- The nomination were for those employees who went above and beyond their regular responsibilities or who made a significant impact on the lives of students or school community.
- Each school and department could nominate no more than two individuals. Locations were not required to nominate an employee.
- All employees should be considered and not just teachers.
- A detailed narrative was required as to why an employee was being nominated.
- **The deadline to submit nominations was August 15, 2018.**

Employee of the Year Awards

Gloria Guzzo

Sarah Hanson

Ernesto Lorenzo

Rose Morrisroe

Larry Willis

Laura Politi

Brenda Cooper Aldowabe

Regina Mckenna Nadblieny

Mariel Johnson

Kirby Smith

Evelyn Fernandez

Jahmel Drakeford

Linda Epps

Vivian Paiz

Barry Devone

Hooman Behzadpour

Kashan Green

Marion Atkins

Adekunle James

Orange Early Childhood Center

Forest Street Community School

Forest Street Community School

Oakwood Avenue Community School

Oakwood Avenue Community School

Orange Preparatory Academy

Scholars Academy

Scholars Academy

Rosa Parks Community School

Heywood Avenue

Heywood Avenue

Curriculum and Instruction

Curriculum and Instruction

Bilingual/ESL

Community Engagement

Orange High School

Deputy Superintendent

Business Office

Business Office